

# Crimp Terminal

## 3746 Series

### TERMINAL PART NO: 3746PS/BS-2

- Material: Phos / BRASS t 0.2
- Pre-plated
- Wire Range: AWG 22-26, 26-32
- Tin 60i " over nickel 40i "
- Q' TY: 10,000Pcs/Roll
- Accepts Housing: 2500H

### SPECIFICATIONS

- Voltage Rating: 250V AC,DC
- Current Rating: 3A AC,DC
- Withstand Voltage: 1,000V AC/min.
- Insulation Resistance: 1,000M  $\Omega$  min.
- Temperature Range: -25°C~+85°C
- Contact Resistance: Initial value/10m  $\Omega$  max.  
After environmental  
Testing/20m  $\Omega$  max.
- Applicable P.C.B. thickness: 0.8~1.6mm

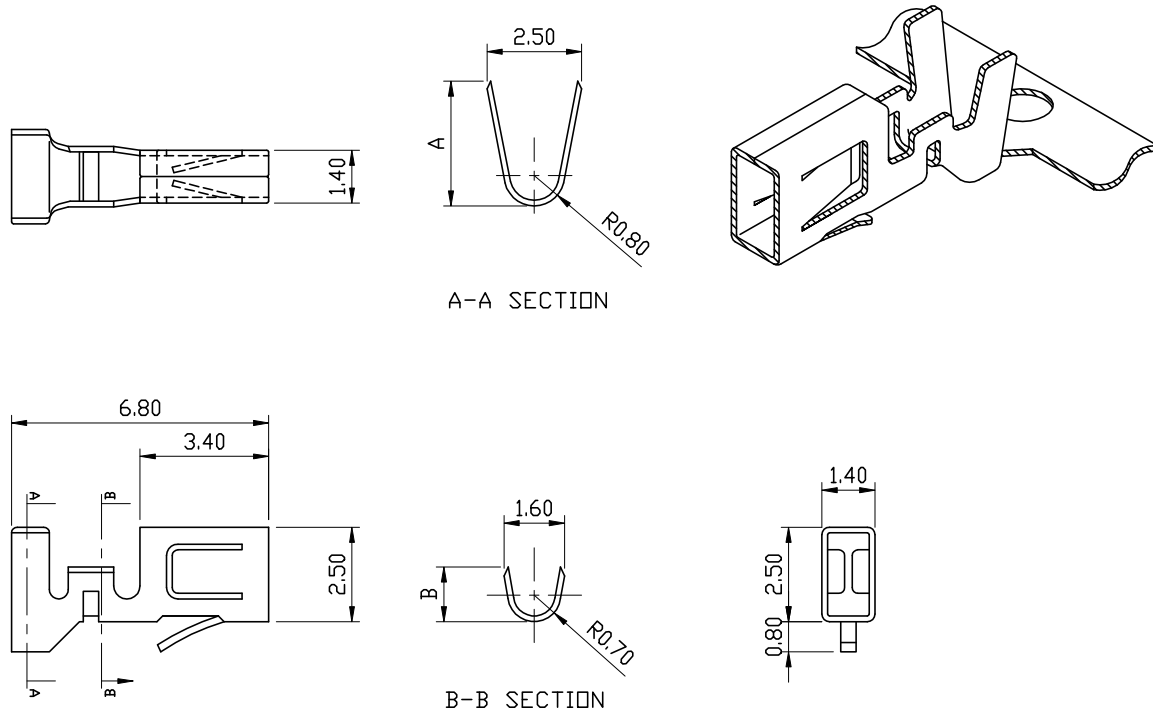

HO TIEN PRECISION INDUSTRY CO., LTD.  
合田精密工業股份有限公司

RECORD OF REVISION / 修定內容	REV.BY / 修定者	REV. DATE / 修定日期	PART NO. / 型號	3746PS/BS-2	APPROVED BY / 核准	
			MATERIAL / 材質		CHECKED BY / 審查	
			TREATMENT / 表面處理		DRAWN / 製圖	
			CUSTOMER / 客戶名稱		DATE / 製圖日期	
			UNIT / 單位	mm	SCALE / 比例	1/2
					DRAWING TYPE / 圖面種類	